

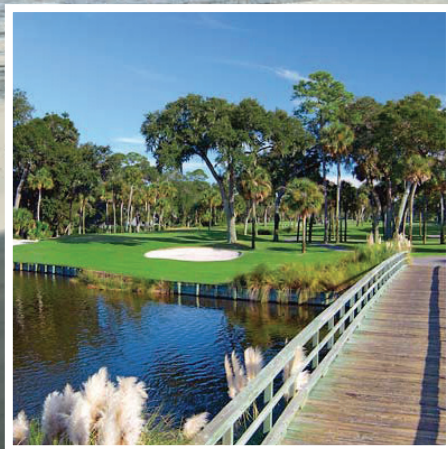

# 44TH ANNUAL NCCCC CONFERENCE AND PROFESSIONAL INSTITUTE

March 9-12, 2016  
The Marriott Resort & Spa  
Hilton Head Island, South Carolina







## Solid Maple Furniture and Toys.

communityplaythings.com

**800-777-4244**



## *Mark Your Calendars for the* **45<sup>TH</sup> ANNUAL NCCCC CONFERENCE AND PROFESSIONAL INSTITUTE**

**March 23-26, 2017**

**The Renaissance Long Beach Hotel**

**111 East Ocean Boulevard • Long Beach, CA**

*Keynote Session, Workshops and Tours*





# NATIONAL COALITION FOR CAMPUS CHILDREN'S CENTERS 44TH ANNUAL NCCCC CONFERENCE AND PROFESSIONAL INSTITUTE

**MARCH 9-12, 2016 • MARRIOTT HILTON HEAD ISLAND • SOUTH CAROLINA**

Welcome to N4C's 44th Annual Conference and Professional Institute in Hilton Head Island, South Carolina. When N4C members are asked why being part of our organization is important we hear about comradery, sharing, networking, finding others with like needs, goals, and perspectives on early education, and the exchange of information and ideas that are pertinent to our unique niche in the early childhood field. N4C members' interests stretch far beyond establishing and maintaining high quality early childhood centers and lab schools. They are also engaged in advocating for funding, recognition, and being valued for the work we do to support the families that populate our universities and colleges. We look for research opportunities and experiment with new techniques and new materials. We are on the forefront of what is good, healthy, and supportive of young children and their families.

The N4C conference encompasses all that our members are and seek to be. Keynote speakers Camille Catlett, a scientist at the Frank Porter Graham Child Development Institute, and Robin Moore, an architect, urban planner, and an international authority on children's play and learning environments, will get you thinking and planning. Over the next three days choose from a wide array of speakers covering a wide range of topics that will surely engage, stimulate, and encourage the exchange of ideas and opinions. There are also sessions about N4C, what this organization is and does, and information on how you can be more involved in advancing quality child care and early education on our nation's campuses.

During your time here, please greet old friends and make new ones. Seek out potential colleagues and collaborators. Share who you are and what you do. But also take the time to wiggle your toes in the sand and relax, refresh, and revitalize.

Best wishes for a great conference experience!

*Pamela Pallas, Ph.D.*

*President*

*National Coalition for Campus Children's Centers*



**Engage • Network • Advocate**



# 44TH ANNUAL NCCCC CONFERENCE AND PROFESSIONAL INSTITUTE



## CONFERENCE-AT-A-GLANCE

### WEDNESDAY, MARCH 9

4:00pm – 6:00pm Registration/Opening Reception

### THURSDAY, MARCH 10

7:30am – 9:00am Registration and Information  
7:30am – 8:00am Continental Breakfast  
7:30am – 4:00 pm Tabletop Exhibits  
8:15am – 8:30am Welcome to NCCCC's 44th Annual Conference & Professional Institute  
8:30am – 9:45am General Session – Keynote Presentation  
10:00am – 11:15am Workshops  
11:30am – 12:30pm Attendee Lunch + Board, Sponsor & Exhibitor Introduction + Annual Report  
12:45pm – 2:00pm Workshops  
2:00pm – 2:15pm Break  
2:15pm – 3:30pm Workshops  
3:45pm – 5:00pm Workshops  
5:15pm – 6:00om Connection and Reflection at Sunset

### FRIDAY, MARCH 11

7:30am – 9:00am Registration and Information  
7:30am – 8:00am Continental Breakfast  
7:30am – 4:00 pm Tabletop Exhibits  
8:30am – 9:45am General Session – Keynote Presentation  
10:00am – 11:15am Workshops  
11:30am – 12:30pm Attendee Lunch + Awards  
12:45pm – 2:00pm Workshops  
2:00pm – 2:15pm Break  
2:15pm – 3:30pm Workshops  
3:45pm – 5:00pm Workshops  
5:15pm – 6:00om Connection and Reflection at Sunset

### SATURDAY, MARCH 12

7:30am – 9:00am Registration and Information  
8:00am – 8:30am Continental Breakfast  
8:00am – 10:00 am Tabletop Exhibits  
8:30am – 9:45am Workshops  
10:00am – 11:15am Workshops



## KEYNOTE SPEAKERS

*Speaking Thursday, March 10, 2016*

### **Camille Catlett**

Camille Catlett is Scientist at the University of North Carolina's Frank Porter Graham Child Development Institute. She has helped over 30 states to organize collaborative professional development efforts that support the full participation of each young child and his or her family, including those who are culturally, linguistically, and ability diverse. Camille is currently working with colleges in eight states to increase the emphasis on exceptionality and inclusion in preservice coursework, practica, and program practices. Camille is a frequent presenter at state, national and international conferences on effective professional development, diversity, interprofessional collaboration, inclusion, and family-professional partnerships. In her spare time, she coordinates the weekly Natural Resources listserv and a regular column on high quality/low cost resources in Young Exceptional Children and serves as an advisor to state and national organizations (e.g., North Carolina Child Care Resource and Referral Council).



Sponsored by



*Speaking Friday, March 11, 2016*

### **Robin Moore**

Robin Moore, Dipl.Arch, MCP, Hon. ASLA, is Professor of Landscape Architecture, College of Design, NC State University, and Director of the Natural Learning Initiative (co-founded with Dr. Nilda Cosco in 2000). Moore holds degrees in architecture, Bartlett School, London University, and city and regional planning, MIT. His research is focused on community-based, evidence-driven, built environment design and the behavioral needs of children and families. Moore supervises doctoral students and teaches field research methods in environment and behavior. He is former chair of the Environmental Design Research Association and former president of the International Play Association. He was a research member of the UNESCO "Growing Up in Cities" program. Recent publications include *Nature Play & Learning Places* (2014); *Growing Up Green: Naturalization as a Health Promotion Strategy in Early Childhood Outdoor Learning Environments*; *Children, Youth and Environments* (2014); *Child-Friendly, Active, Healthy Neighborhoods: Physical Characteristics and Children's Time Outdoors*; *Environment and Behavior* (2014); and *Design for Healthy Childhoods and a Healthy Planet*, in *Biophilic Design* (2008).



Sponsored by



# NATIONAL COALITION FOR CAMPUS CHILDREN'S CENTERS

## 44TH ANNUAL NCCCC CONFERENCE AND PROFESSIONAL INSTITUTE



### SCHEDULE OF EVENTS • THURSDAY, MARCH 10, 2016

7:30am-9:00am East Foyer

**Registration & Information**

7:30am-8:00am East Foyer

**Continental Breakfast**

7:30am- 4:00pm East Foyer

**Tabletop Exhibits**

8:15am-8:30am

**Welcome to NCCCC's 44th Annual Conference & Professional Institute**

*Tonya Palla, Executive Director, NCCCC, and  
Pamela Pallas, Ph.D., President, NCCCC*

8:30am-9:45am Ballroom ABC

**General Session-Keynote Presentation: Natural Resources: Evidence-Based Practices for Supporting Each Child and Family**

Efforts to prepare future early childhood professionals who are comfortable, confident and capable to support each child and family grow more complicated every day. Both children and families are more diverse in terms of culture, language, ability, experiences and expectations. Effective professionals need a repertoire of resources on which to draw for information, examples, ideas, and ongoing support. This address will share high quality, no cost examples that faculty members, center directors, and other early childhood leaders can use to prepare future early childhood colleagues to incorporate evidence, engage families, embrace diversity, promote effective practice, and pursue continuous improvement.

*Camille Catlett, Scientist, Frank Porter Graham Child Development Institute*

10:00am-11:15am Ballroom D

**Constructing Consistent Foundations Through Your Center's Policies and Procedures**

*Kelly Jamison, M.S., and Stacy Ellis, Ph.D., University of Florida*  
Come join the consistency campaign and learn how to implement consistent policies and procedures, curriculum tracking, and compliance measures. See how consistency in these areas can impact your center's overall program performance  
*Policies and Procedures-Programs*

10:00am-11:15am Ballroom E

**AdvancED Early Learning Accreditation: Where DAP Meets Rigor and Quality**

*Holly King, M.A., AdvancED*  
The goal of the presentation is to introduce participants to the benefits of AdvancED Accreditation for Early Learning Schools, which support the learning, growth and development of young children in a culture of continuous improvement.  
*Standards-Administration*

10:00am-11:15am Ballroom F

**E in STEM: Demystifying Engineering**

*Constant Hine, M.A.T., Kodo Kids*  
Identify ways engineering is happening everyday in the classroom and how to facilitate and build on those experiences through play and investigation to intentionally foster STEM skills in children. Come learn with hands on materials!  
*All Ages-Administration*

10:00am-11:15am Sabal Palm Jr. Ballroom

**Using Data to Make Your Case-CCAMPIS and Beyond**

*Jen Templin, B.S. University of Wisconsin-Madison, and  
Betty Pearsall, M.S., M.Ed., City University of New York*  
With an increasing pressure on campus children's programs to prove their effectiveness, this session will guide you through everything you need to start gathering student parent data to show the VALUE of your program to your funders, including CCAMPIS.  
*Advocacy-Administration*

11:30pm-12:30pm Ballroom A-C

**Attendee Lunch + Board, Sponsor & Exhibitor Introduction + Annual Report**

12:45pm- 2:00pm Ballroom D

**Our Trip to the White House: A Guide for Ethics, Collaborations and Accommodation**

*Lisa Gannoe, Ed.D, Dana Bush, Ph.D., and Carol Patrick, Ed.D., Eastern Kentucky University*  
The goal of the presentation is to assist participants in gaining insight into their campus policies, department procedures, and campus resources in order to address ethical dilemmas and issues of student accommodations productively and proactively.  
*Ethics, Collaborations, Accommodations-Campus Collaboration*

12:45pm- 2:00pm Ballroom E

**Assessing Birth-5 Teaching Methods at University Laboratory School**

*Alice Hall, Ph.D., John Peden, Ph.D., and Trent Maurer, Ph.D., Georgia Southern University*  
This presentation highlights the findings from a longitudinal study that evaluated the effectiveness of a four-year university undergraduate degree that partners with a university laboratory school serving children from 6 weeks to 5 years.  
*Teacher Education-Programs, Campus Collaboration, Faculty*

12:45pm- 2:00pm Ballroom F

**ABCs, Partnerships and Collaborations to Ensure High Quality Care**

*Janet McIntosh, M.ED., and Kathy Phillips Harding, City University of New York, Medgar Evans College*  
The goal of this presentation is to assist participants in establishing effective, strong partnerships and collaborations as an important component in child care programs. Identify steps that can be taken to identify who partners should be and establish the partnerships.  
*All Ages-Programs*





## SCHEDULE OF EVENTS • THURSDAY, MARCH 10, 2016

**12:45pm- 2:00pm**

**Sabal Palm Jr. Ballroom**

### **CCAMPIS Grant: More than Student Funding; Increasing Student Retention and Graduation Rates**

*Cynthia Neale-Downing, M.A., and Joneila Henselman, B.S., Pikes Peak Community College*

Pikes Peak Community College will share their challenges, successes and outcome data for their CCAMPIS grant including a collaborative, comprehensive program of student requirements aimed at increasing student retention, academic success and completion.

*CCAMPIS-Administration*

**2:00pm-2:15pm**

**East Foyer**

### **Break**

**2:15pm-3:30pm**

**Ballroom D**

### **Family First Building Connections**

*Nika Douglas, M.Ed., and Katie White, B.A., University of Florida*

This presentation will demonstrate how involvement with families in special activities builds connections between the children, teachers, families, and community at large. Participants will be provided with tools to immediately implement these ideas.

*All Ages, Diversity, Family Involvement-Programs*

**2:15pm-3:30pm**

**Ballroom E**

### **Student Parent Child Care Needs: A Successful Hourly Program Model**

*Kate Kausch, M.A., and Shauna Lower, B.A., University of Utah*

The goal of the presentation is to help participants gain an understanding of the tools necessary to run a successful, quality program to help meet the unique care needs of student-parents.

*Student Parent Support-Administration*

**2:15pm-3:30pm**

**Ballroom F**

### **Leo the Late Bloomer: Children with Special Needs**

*Jennifer Gibbons, B.S.*

The goal of the presentation is to offer strategies to assist participants in recognizing developmental concerns, observing children and documenting their skills and behaviors, and partnering with families to help children reach their full potential.

*SPED-Programs*

**2:15pm-3:30pm**

**Sabal Palm Jr. Ballroom**

### **Teaching Team Meetings as Sites for Developing Knowledge of Children's Social and Emotional Development**

*Cynthia Paris, Ph.D., Lauren Stegeman M.S., University of Delaware*

Video documentation and analysis of opportunities for social and emotional learning in structured teaching team meetings will be examined and discussed. Emphasis on early field experience students but with implications for learning of all staff.

*Teacher Education, All Ages-Programs*

**3:45pm-5:00pm**

**Ballroom D**

### **Brainstorming and Problem Solving in Early Childhood Classrooms**

*Pam Morbitzer, M.S., and Lisa Lee, B.S., Illinois State University Child Care Center*

The goal of the presentation is to provide early childhood educators with a variety of brainstorming and problem-solving activities to enhance the executive function and critical thinking skills of young children.

*Preschool-Programs*

**3:45pm-5:00pm**

**Ballroom E**

### **Southampton's Approach: Significance of Play Through NYS, PreK Common Core Standards**

*Vickie F. Calderon, Ed.M., Suffolk County Community College, and Bertha Richard, E.D., Southampton Elementary School*

If the importance of play is proven by scientific research, why is it currently being pushed out of preschool and kindergarten? Southampton Principal and ECE Consultant will discuss the challenges and successes of interpreting and implementing NYS PreK Common Core Standards through everyday play. E. Miller & J. Almon's book, "Crisis in the Kindergarten-Why Children Need to Play in School" will be discussed. Participants will have the opportunity to ask questions and obtain information regarding the impact of play.

*Advocacy, Preschool Standards-Leadership, Programs, Collaboration*

**3:45pm-5:00pm**

**Ballroom F**

### **Practical Family Support: Strategies for Administrators**

*Maggie Lane Rosenblum, M.A., and Sharon M. Carver, Ph.D., Carnegie Mellon University Children's School*

Experienced administrators will share diverse strategies for supporting families and educators who work more directly with them. Support topics will include orientation, relationship building, parenting education, resource & referral, and consultation regarding life transitions, English language learning, special needs, etc.

*All Ages-Administration*

**3:45pm-5:00pm**

**Sabal Palm Jr. Ballroom**

### **NCCCC New Director's Workshop**

*Pamela Pallas, Ph.D., University of Florida*

Seasoned campus center directors lead a panel discussion on issues commonly facing new directors, including budgets, staffing and center-campus relations.

*Directors, Management Training*

**5:15pm-6:00pm**

**Beach Front**

### **Connection and Reflection at Sunset**

# NATIONAL COALITION FOR CAMPUS CHILDREN'S CENTERS

## 44TH ANNUAL NCCCC CONFERENCE AND PROFESSIONAL INSTITUTE



### SCHEDULE OF EVENTS • FRIDAY, MARCH 11, 2016

<b>7:30am-9:00am</b>	<b>Palmetto</b>	<b>10:00am-11:15am</b>	<b>Sabal Palm Jr. Ballroom</b>
<b>Board Meeting</b>		<b>Using Teachers' Voices in the Evaluation Process</b>	
<b>7:30am-9:00am</b>	<b>East Foyer</b>	<i>Sharon Mims, Ph.D., University of North Carolina at Greensboro</i>	
<b>Registration &amp; Information</b>		Workshop will provide examples of techniques and opportunities for sharing of ideas used to incorporate input from teachers in the process of evaluation and "norming" of practices in early childhood programs.	
<b>7:30am-8:00am</b>	<b>East Foyer</b>	<i>All Ages-Administration</i>	
<b>Continental Breakfast</b>		<b>11:30pm-12:30pm</b>	<b>Ballroom A-C</b>
<b>7:30am-4:00pm</b>	<b>East Foyer</b>	<b>Attendee Lunch + Awards</b>	
<b>Tabletop Exhibits</b>		<b>12:45 pm-2:00pm</b>	<b>Ballroom D</b>
<b>8:30am-9:45am</b>	<b>Ballroom ABC</b>	<b>Children with Special Needs: Social Integration Methods at Reggio Inspired Centers</b>	
<b>General Session-Keynote Presentation: Campus Childcare as a Vanguard of Health Promotion</b>		<i>Barb O'Neill, Ed.D., Fresno State University</i>	
How can campus childcare become a beacon of light in higher education and paragon of health promotion, helping children learn habits of active living and healthy eating, good for the rest of life? Evidence supporting the role of nature in early childhood and a new outdoor learning environment model will be shared.		Learn how the use of documentation and reflection combined with the introduction of theater improv-based play support methods enabled children and staff at one center to develop based on their individual interests, strengths and needs.	
<i>Professor Robin C. Moore, Natural Learning Initiative, North Carolina State University</i>		<i>SPED-Programs</i>	
<b>10:00am-11:15am</b>	<b>Ballroom D</b>	<b>12:45 pm-2:00pm</b>	<b>Ballroom E</b>
<b>Exploring the Relationship Between Nature, Design and Early Learning Inside and Out</b>		<b>It Takes a Campus: Collaborations Across Our Community College Campus</b>	
<i>Mike Lindstrom, studioMLA Architects, and Robin Moore, NLI/North Carolina State University</i>		<i>Sherry K. Granberry, M.S., Jodi B. Baker, M.A., and Phyllis H. Chesson, B.S., Wayne Community College</i>	
The session will give participants new insights into the importance of and strategies for implementing the integration of nature and sustainability into children's environments and curriculum.		The goal of the presentation is to share one child care center's many partnerships with the academic departments and programs across the community college campus and community.	
<i>Environments-Programs</i>		<i>Teach Education, All Ages-Campus Collaboration</i>	
<b>10:00am-11:15am</b>	<b>Ballroom E</b>	<b>12:45 pm-2:00pm</b>	<b>Ballroom F</b>
<b>"Open Space" Discussion</b>		<b>21st Century Learning laboratory Student Development Through Electronic Portfolios</b>	
<i>Dana Bush, Ph.D., Eastern Kentucky University, Michelle Rupiper, University of Nebraska, Omaha, and Daniela Baca, University of New Mexico</i>		<i>Sharon Wilbanks, M.S., Emily Cumbie, M.S., and Margaret Vollenweider, M.S., Auburn University</i>	
The session will be structured by the attendees and lead by a panel from NCCCC Board of Directors.		The goal of this session is to introduce the concept of an e-portfolio and explore the value of incorporating it into lab student coursework. Participants will see student e-portfolio examples, grading rubrics, and relevant assignments.	
<b>10:00am-11:15am</b>	<b>Ballroom F</b>	<i>Teacher Education-Faculty</i>	
<b>Early Development Screening Informs Early Intervention: What is NCCCC Doing?</b>		<b>12:45 pm-2:00pm</b>	<b>Sabal Palm Jr. Ballroom</b>
<i>Shirley Leew, Ph.D., ASPIIRE, and Pamela Pallas, Ph.D., University of Florida</i>		<b>Interns as Co-Teachers in a University Laboratory Preschool: Does it Work?</b>	
This interactive presentation will stimulate group discussion about the state of early identification and intervention across NCCCCs in the US and in Canada and will provide a group generated 'map' of ideal service.		<i>Sara Melendrez, M.A., and Christina Ruybal, M.A., New Mexico State University</i>	
<i>Infants, Toddlers-Programs</i>		The goal of our presentation is to share the New Mexico State University pilot Early Childhood Apprentice Program and evaluate its effect on our Reggio-inspired laboratory school's program philosophy, teachers, and support staff.	
		<i>Teacher Education-Faculty</i>	





## SCHEDULE OF EVENTS • FRIDAY, MARCH 11, 2016

**2:00pm-2:15pm**

**East Foyer**

**Break**

**2:15pm-3:30pm**

**Ballroom D**

### **When Tuition Isn't Enough! Increasing Funds for Your Program Through Special Projects, Events, and Grants**

*Stacy Ellis, Ph.D., and Nika Douglas, M.Ed., University of Florida*  
Have you found that tuition and state funding doesn't provide enough income for your quality program? Look no further! Come learn tips on how to raise additional funds through special projects, events, and grants.

*Fundraising-Administration*

**2:15pm-3:30pm**

**Ballroom E**

### **This One is Yours, This One is Mine**

*Amy Kay, Ph.D., and Lori Maerz, M.A., University of Georgia*  
The goal of the presentation is to provide insight into how the personality and communication style of multiple administrators can be acknowledged and used effectively to form positive professional relationships with parents and teachers.

*Administration-Administration*

**2:15pm-3:30pm**

**Ballroom F**

### **Tales from Scotland's Nature Kindergarten and America's Journey**

*Sara Garner, EdD, Southeast Missouri State University, and Michelle Rupiper, PhD, University of Nebraska-Lincoln*  
This interactive presentation will share the journey of the Scotland Nature Study Tour. Participants will view detailed photographs of Scotland's Nature Kindergartens, define nature pedagogy and discuss strengths and challenges of working in an outdoor world as well as children, families, and staff that may have a nature phobia.

**2:15pm-3:30pm**

**Sabal Palm Jr. Ballroom**

### **Program Leadership: Coaching to Support Dual Language Learners**

*Jillian Clemens, B.A., University of Wisconsin-Madison*  
The goal of the presentation is to facilitate participants understanding of what coaching is, how coaching can help program leaders improve program quality for serving dual language learners, and how coaching can assist in furthering a programs practices in partnering with the families of dual language learners.

*Preschool, Kindergarten-Leadership*

**3:45pm-5:00pm**

**Ballroom D**

### **Curriculum of Passion: Supporting Interests and Potentials of Children and Graduate Students**

*Marisa S. Chin-Calubaquib, M.Ed., Hollingworth Preschool-Teachers College, Columbia University*  
Campus schools are uniquely positioned to support young children and graduate students in the daily life of the classroom. This presentation highlights ways to foster and nourish the creative spirits of both through the curriculum.

*Teacher Education, Preschool, Diversity-Programs, Collaborations*

**3:45pm-5:00pm**

**Ballroom E**

### **Designing the Classroom of Tomorrow: Digital Documentation**

*Susan Testaguzza, CEO, LifeCubby*  
What technology solutions are deployed in the most tech-forward ECE programs today? What will we see in the next 3-5 years? For the teachers, the children, administrators and even parents, in this session we will explore the technology solutions you should be considering for your programs. Both software and hardware solutions will be discussed for marketing, curriculum, documentation, management and communications. Infrastructure considerations will be included, plus we will share the results of exciting research on classroom hardware options.

*All Ages-Administration*

**3:45pm-5:00pm**

**Ballroom F**

### **Advisory Boards that Work**

*Pamela Pallas, Ph.D., University of Florida, and Diane Nicolet, Ph.D., University of Nevada, Reno*  
This interactive presentation will discuss establishing, supporting, and working effectively with a Board of Directors, an Advisory Board, a Parent-Teacher Board and Boards with a special purpose, focusing on a Board's purpose and value to your organization.

*All Ages-Administration*

**3:45pm-5:00pm**

**Sabal Palm Jr. Ballroom**

### **NCCCC Introduction to Committee Work**

*Candace Jaruszewicz, College of Charleston, Lorraine Breffni, Nova Southeastern University, and Susan Rosen, Humboldt University*  
NCCCC would like to invite you to be more involved in the organization. Ever wonder what the board and committees focus on and how these contributions affect member networking, engagement and move the field of early childhood education forward? Come to this session and find out!

**5:15pm-6:00pm**

**Beach Front**

### **Connection and Reflection at Sunset**

# NATIONAL COALITION FOR CAMPUS CHILDREN'S CENTERS

## 44TH ANNUAL NCCCC CONFERENCE AND PROFESSIONAL INSTITUTE



### SCHEDULE OF EVENTS • SATURDAY, MARCH 12, 2016

7:30am-9:00am East Foyer

**Registration & Information**

8:00am-8:30am East Foyer

**Continental Breakfast**

8:00am-10:00am East Foyer

**Tabletop Exhibits**

8:30am-9:45am Ballroom A

**Connecting Preschool Teachers to Nature Classrooms and Expanding to Other Majors**

*Sara Garner, EdD, Southeast Missouri State University*  
This interactive presentation will share the journey of creating Nature Literacy and the evolution of the class across campus. Participants will engage in nature activities and discuss strengths and challenges of teaching pre-service teachers in an outdoor world as well as students who come from majors unrelated to teaching children.

8:30am-9:45am Ballroom B

**Happy Staff, Happy Center: Building Skills While Building Morale**

*Katie White, B.A., and Kelly Jamison, M.S., University of Florida*  
Without question the number one challenge facing Early Childhood Centers is employee turnover. This presentation will address the some of the major causes of employee turnover and how best to alleviate it using nonmonetary sources and creative efforts.  
*Leadership-Administration*

8:30am-9:45am Ballroom C

**Collaborative Approach to Innovative Teaching**

*Anna Burton, M.A., and Sarah Wade, B.A., Baylor University*  
Participants will learn how collaboration strengthens innovative teaching through personal anecdotes and research. Participants will leave the session with practical strategies for the implementation of collaboration among professionals and students while enhancing their leadership qualities  
*Collaboration, Leadership-Leadership*

8:30am-9:45am Ballroom D

**First Impressions: What Does Your Environment Say to Parents**

*Susan H. Venatta, D.Ed., Karen Scarton, D.Ed., and Fredalene Bowers, Ph.D., Indiana University of Pennsylvania*  
The goal of this workshop is to help participants gain a different visual perspective of their learning and teaching environment, and suggest solutions that address the use of color, lighting, and organization in said environment.  
*All Ages-Programs*

8:30am-9:45am Ballroom E

**Natural Teaching: Tomato Hornworm Project**

*Sarah Goodyear Charney, and Kathryn Owen, M.S., University of California at San Diego*  
Teaching can be effortless! Experience the joy and wonder of a natural learning experience inspired by the unexpected arrival of the tomato horn worm in a toddler classroom.  
*Infants-Programs, Teaching*

8:30am-9:45am Ballroom F

**Intentional Partnership Development to Support Program Success**

*Susan Rosen, M.A., and Elizabeth Anne Wilson, M.A., Humboldt State University*  
The goals of this presentation is to give participants tools through which to evaluate their current partnerships, imagine new ones and articulate the value of their own program's participation and role within those partnerships.  
*All Ages-Administration*

10:00am-11:15am Ballroom A

**Everybody Loves You Until You're the Boss**

*Mary Schumacher-Hoerner, San Juan College*  
How can new directors navigate changing their role from colleague to supervisor? The presenter will share her own challenges and rewards as a jumping off place for other participants to contribute their own experiences.  
*All Ages-Administration*

10:00am-11:15am Ballroom B

**Meaningful Interactions with Infants**

*Shirley Leew, Ph.D., ASPIRE*  
The goal of this presentation is to develop awareness of the importance of gestures, to provide skill in recognizing their development, and to provide strategies to enhance gesture development in infants and toddlers.  
*Infants, Toddlers-Programs*

10:00am-11:15am Ballroom C

**Respecting Infants in the Classroom**

*Jennifer Glass, B.S., University of Cincinnati*  
The goal of this presentation is to teach the importance of respect for infants and how to promote that value in the classroom. Participants will learn practical ways to show respect to infants.  
*Infants-Programs*

10:00am-11:15am Ballroom D

**Brain States, Executive Skills and Behavior**

*Ida Bauer, University of Colorado Colorado Springs - Family Development Center*  
Challenging behaviors in classrooms are on the rise. This brain researched based Conscious Discipline® presentation focuses on brain states, behaviors and the formation of executive skills to help decrease challenging behaviors  
*All Age Groups-Programs*





## SCHEDULE OF EVENTS • SATURDAY, MARCH 12, 2016

10:00am-11:15am

Ballroom E

### **Fighting Fires and Rocking Babies: One Classroom's Journey with a Project Approach**

*Karen Rattenborg, Ph.D., and Emily Murphy, Colorado State University*  
This presentation explores Project Based Learning in the context of a Reggio Emilia-inspired lab school and shares the story of an exemplary teacher as she effectively implemented the project approach in her classroom.

*Preschool-Programs*

10:00am-11:15am

Ballroom F

### **Look at Them Go-Using a GoPro Camera as a Class Resource**

*Cristina Hernandez, University of Florida*

The goal of this presentation is to learn multiple ways in which strapping a sturdy video camera onto a child can give you insight on child development, lesson planning and parent communication

*All Ages-Programs*

## 2016 AWARDS & GRANTS WINNERS

Congratulations to the recipients of the 2016 NCCCC Awards and Grants!  
These winners will be recognized during lunch on Friday.

### DIRECTOR OF THE YEAR AWARD

Winner will receive complimentary registration to the 2017 NCCCC Annual Conference

***Stacey Smith-Clark, Long Beach City College Child Development Center***

and

***Sherry Waugh, University of Nevada, Child and Family Research Center***

### THE AMBASSADOR AWARD – SPONSORED BY STUDIO MLA



Winner receives a 50% grant towards the conference registration fees of a member AND a non-member.

***Sue Barnett, Red Rocks Community College, The Children's Center***

### THE AMBASSADOR AWARD – SPONSORED BY THE NATIONAL COALITION FOR CAMPUS CHILDREN'S CENTERS

Winner receives a 50% grant towards the conference registration fees of a member AND a non-member.

***Kathryn Owen, University of California, San Diego***

### THE AMBASSADOR AWARD – SPONSORED BY THE NATIONAL COALITION FOR CAMPUS CHILDREN'S CENTERS

Winner receives a 50% grant towards the conference registration fees of a member AND a non-member.

***Barbara Crosby, Baylor University***

NATIONAL COALITION FOR  
CAMPUS CHILDREN'S CENTERS

44TH ANNUAL  
NCCCC CONFERENCE AND  
PROFESSIONAL INSTITUTE



2016 ANNUAL CONFERENCE SPONSORS

The National Coalition for Campus Children's Centers would like to sincerely thank the exhibitors and sponsors of the 44th Annual Conference. Their continued support of the early childhood education field in general, and of NCCCC specifically, is recognized and appreciated.

PLATINUM SPONSOR



GOLD SPONSOR



GRANT SPONSOR



2016 ANNUAL CONFERENCE EXHIBITORS

**Platinum Sponsor**

**Community Playthings**

Eric Nelson  
ericnelson@communityproducts.com  
P.O. Box 2  
Ulster Park, NY 12487  
845-943-6316  
www.communityplaythings.com

**Platinum Sponsor**

**Community Playthings**

Christine Nelson  
exhibits@communityplaythings.com  
P.O. Box 2  
Ulster Park, NY 12487  
845-572-3435  
www.communityplaythings.com

**Kodo Kids**

Bill Baron  
info@kodokids.com  
155 Alter Street, Unit A  
Broomfield, CO 80020  
720-340-2704  
www.kodokids.com

**Rocky Mountain Sunscreen**

Caleb Scott  
info@rmsunscreen.com  
14700 W. 66 Place, Suite 2  
Arvada, CO 80004  
303-940-9803  
www.rmsunscreen.com

**LifeCubby**

Susan Tetaguzza  
susant@lifecubby.me  
5193 Ainsley  
Westerville, OH 43082  
614-432-4917  
www.lifecubby.me

**Kaplan Early Learning Company**

Pam Bradley  
mstewart@kaplanco.com  
P.O. Box 609  
Lewisville, NC 27023  
336-712-3203  
www.kaplanco.com

**Learning Genie, Inc.**

Gene Shi  
info@learning-genie.com  
2382 Faraday Avenue  
Carlsbad, CA 92008  
760-576-4822  
www.learning-genie.com





## BOARD OF DIRECTORS & CONFERENCE COMMITTEE

### BOARD OF DIRECTORS, OFFICERS

Pamela Pallas, President, University of Florida  
Dana Keller Bush, President Elect, Eastern Kentucky University  
Beth Hatcher, Secretary, University of Maine, Farmington  
Kimberly Kramer, Treasurer, Wright State University

### BOARD OF DIRECTORS, MEMBERS AT LARGE

Daniela Baca, University of New Mexico  
Lorraine Breffni, Nova Southeastern University  
Jane Glasgow, Old Dominion University  
Julie Graden, Iowa State University  
Candace Jaruszewicz, College of Charleston  
Diane Nicolet, Truckee Meadows Community College  
Susan Rosen, Humboldt State University  
Michelle Rupiper, University of Nebraska-Lincoln

### EXECUTIVE DIRECTOR

Tonya Palla, National Coalition for Campus Children's Centers

### 2016 CONFERENCE COMMITTEE

*The National Coalition for Campus Children's Center's Board of Directors, Members and Conference Attendees, would like to sincerely thank the Conference Committee for their dedication and hard work. Your efforts are appreciated!*

Pamela Pallas, University of Florida  
Dana Keller Bush, Eastern Kentucky University  
Michelle Rupiper, University of Nebraska-Lincoln  
Daniela Baca, University of New Mexico  
Lynn Edlefson, University of Wisconsin-Madison

# 44TH ANNUAL NCCCC CONFERENCE AND PROFESSIONAL INSTITUTE



## CERTIFICATE OF ATTENDANCE

*presented to*

Thursday, March 10, 2016

8:30am – 9:45am      Keynote Session

10:00am – 11:15am      Workshop Title

2:15pm – 3:30pm      Workshop Title

3:45pm – 5:00pm      Workshop Title

Friday, March 11, 2016

8:30am – 9:45am      Keynote Session

10:00am – 11:15am      Workshop Title

12:45pm – 2:00pm      Workshop Title

3:45pm – 5:00pm      Workshop Title

Saturday, March 12, 2016

8:30am – 9:45am      Keynote

10:00am – 11:1am      Workshop Title





## MARRIOTT FLOORPLAN

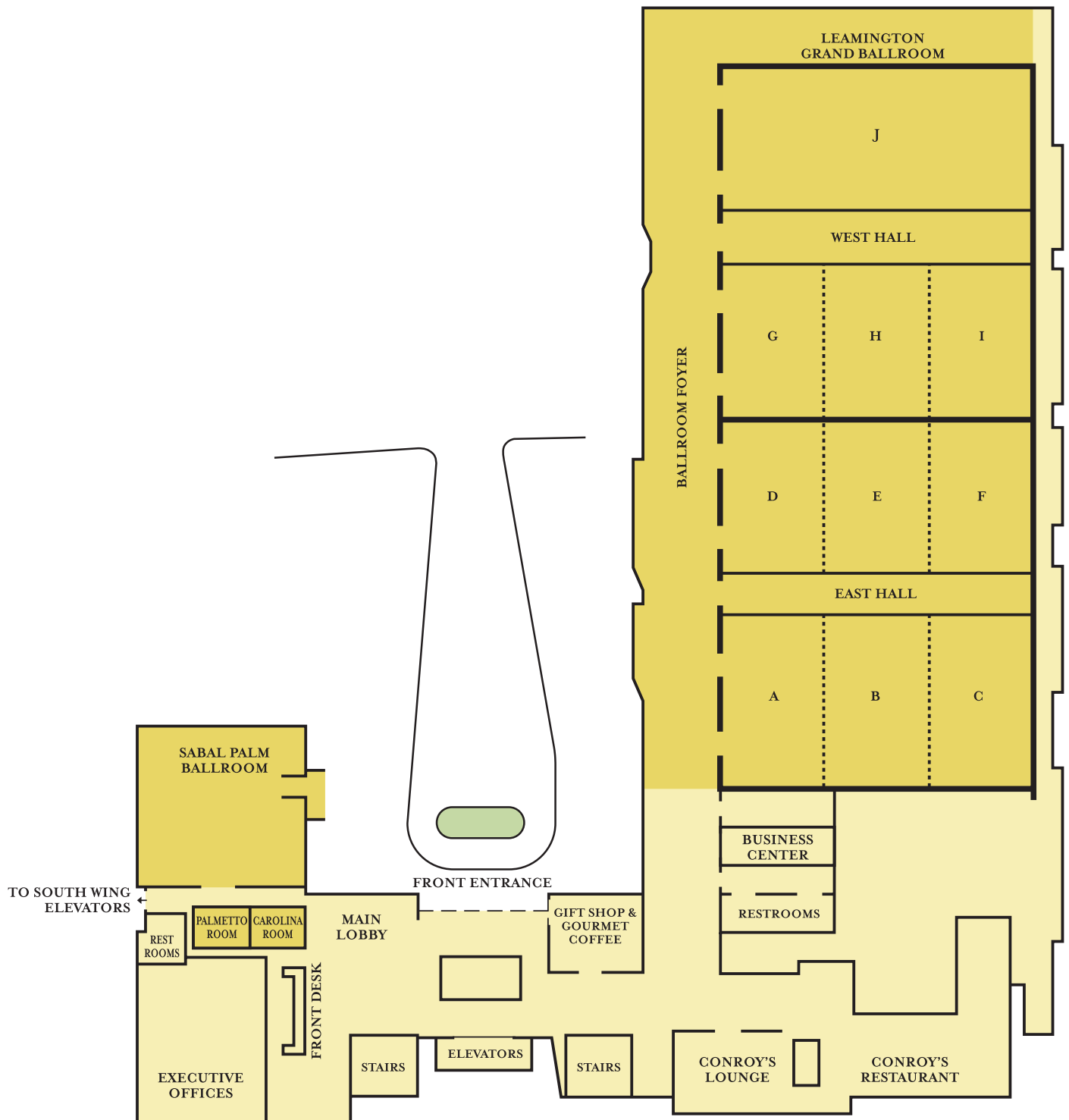



# The Power of Play



**For young children, play is learning.**